

TITLE:

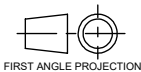

IF IN DOUBT ASK

**PROPRIETARY AND CONFIDENTIAL**  
THE INFORMATION CONTAINED IN THIS DRAWING IS THE SOLE PROPERTY OF OBERON PERFORMANCE LIMITED.  
ANY REPRODUCTION IN PART OR AS A WHOLE WITHOUT THE WRITTEN PERMISSION OF OBERON PERFORMANCE LIMITED IS PROHIBITED.



11 Havant Business Centre  
Harts Farm Way  
Havant  
Hampshire  
PO91 HU  
UK  
Tel: +44 02392 481 188  
Fax: +44 02392 492 458  
admin@oberon-performance.co.uk  
Web: oberon-performance.co.uk  
© Oberon Performance Limited

REVISIONS  
REV DESCRIPTION DATE

| ITEM NO. | DESCRIPTION           | QTY. |
|----------|-----------------------|------|
| 1        | C286 Lever Assembly   | 1    |
| 2        | M4 x 8 Fastener       | 1    |
| 3        | Spring Sleeve         | 1    |
| 4        | Torsion Spring        | 1    |
| 5        | 8mm External Circlip  | 1    |
| 6        | 10mm External Circlip | 1    |

Important Assembly Suggestions

- (1) Remove the perch from the handlebar to aid access.  
(2) Swap out the **OEM Microswitch Actuator** from the original lever and attach to the new lever using the M4 x 8 fastener(2) supplied.  
(3) Insert the short leg of the Torsion Spring(4) into the small hole before inserting the Spring Sleeve(3)  
(4) Use a pair of long nosed needle pliers to help locate the torsion spring into the oem perch location channel before pushing home the assembly.

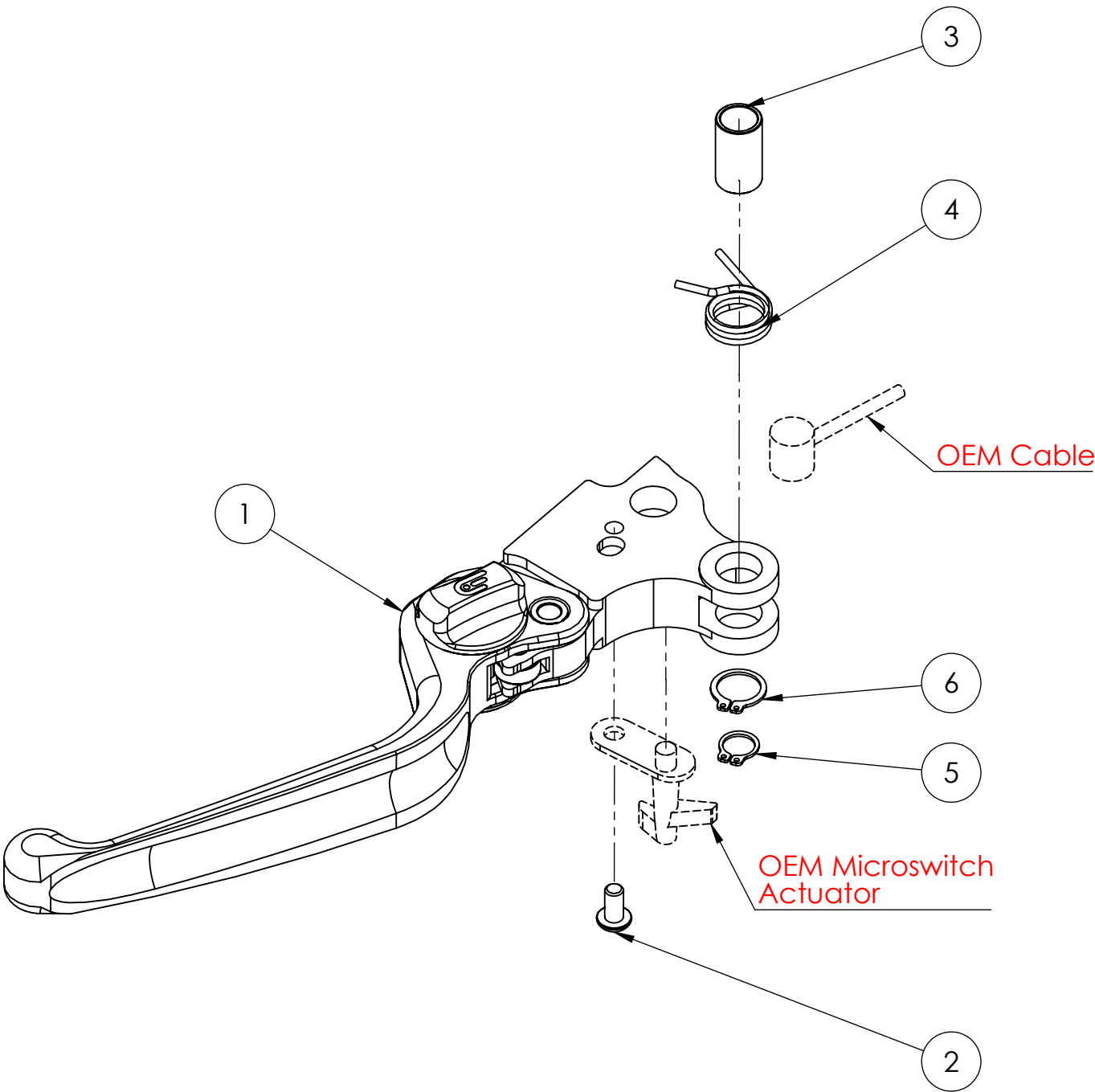

|  |      |                                    |      |
|--|------|------------------------------------|------|
| DO NOT SCALE DRAWING   |      | REVISION                           |      |
|  | NAME | SIGNATURE                          | DATE |
| DRAWN  |      |                                    |      |
| CHK'D  |      |                                    |      |
| APPV'D   |      |                                    |      |
| MFG  |      |                                    |      |
| Q.A  |      |                                    |      |
| UNLESS OTHERWISE SPECIFIED:<br>DIMENSIONS ARE IN MILLIMETERS<br>TOLERANCES:<br>LINEAR: +/- 0.10<br>ANGULAR: +/- 0.5° |      | DEBURR AND<br>BREAK SHARP<br>EDGES |      |
| FINISH:  |      |                                    |      |
| WEIGHT:  |      | MATERIAL:                          |      |
| TITLE:   |      |                                    |      |
| DWG NO.  |      | C286 Instruction Supplement        |      |
| SCALE:1:5  | A3   | SHEET 1 OF 1                       |      |