

# Installation Instructions

## Front Footpeg Kit

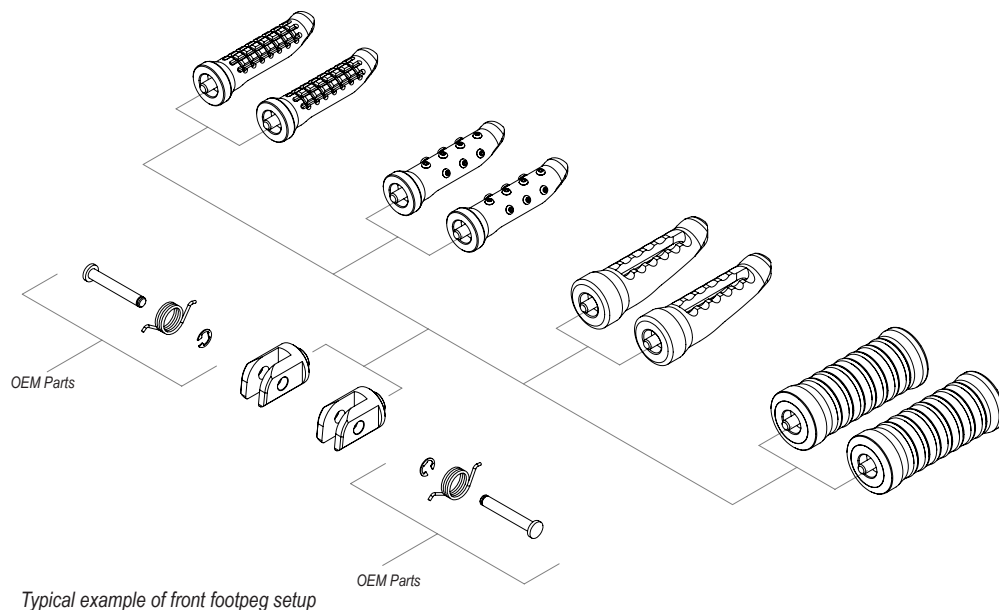

### Preparation:

Before installing your new purchase please read and understand these instructions fully and make sure you have the required tools at hand. These are bike specific replacement front footpegs and therefore please make sure they are designed for your bike. This information is available from our website: [www.oberon-performance.co.uk](http://www.oberon-performance.co.uk)

### Installing the Front Footpeg:

Please read instructions fully before commencing

1. Remove any bodywork or covers (where necessary) to ensure the entire area is easily accessible. The bike will need to be held upright.
2. Remove original front footpeg. **IMPORTANT: Keep all OEM fasteners, springs, ball bearings etc**  
Some manufactures front footpegs are riveted on. The rivet head will need to be drilled off to remove the pin. If your model has this type of fitting a replacement nut and bolt is supplied as part of the kit.
3. Meticulously clean the footpeg hanger frame and all original parts.
4. Loosely bolt the footpeg to the adaptor using the M6 bolt.
5. Replace the footpeg using all of the relevant OEM fittings. If the adaptor needs specific parts these will be supplied in the kit.
6. Move the footpeg up and down and check for any clearance issues, jamming and that it locks in place in either the up or down position.
7. Finally rotationally adjust the footpeg to the desired position and final tighten.